

Klipsch®



CP-T SERIES

OWNER'S MANUAL

CP-T SERIES

Thank you for your purchase of the Klipsch CP-T Series 70/100 Volt speakers! They are designed to both withstand the rigors of outdoor use while also complimenting any indoor décor. The 90°x 90° horn dispersion pattern assures wide, even coverage with either horizontal or vertical placement. The long-throw woofers are combined with front-firing ports for tight, musical bass no matter how they are mounted or placed. The included, unique speaker bracket allows for not only quick vertical or horizontal mounting but also allows for tight, wall/wall or wall/ceiling corner mounting for a highly aesthetic look that allows for increased overall bass output.

The CP-4T contains a high quality, built-in 70/100 Volt transformer with a single, fixed 5/10 watt tap while the CP-6T contains a 70/100 Volt transformer with multiple tap settings of 3.75/7.5 watts, 7.5/15 watts, 15/30 watts and 30 watt taps. The CP-6T also has an 8 ohm bypass setting for 8 ohm operation.

WHAT'S INSIDE

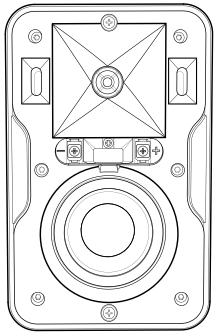

Speakers (x2)

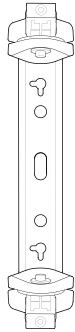

Brackets (x2)

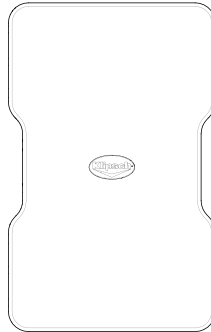

Grills (x2)

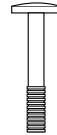

Bracket Retaining
Screws (x4)



Mounting Template



Grill Remover Tool

SPEAKER DIMENSIONS WITH/WITHOUT INCLUDED BRACKETS

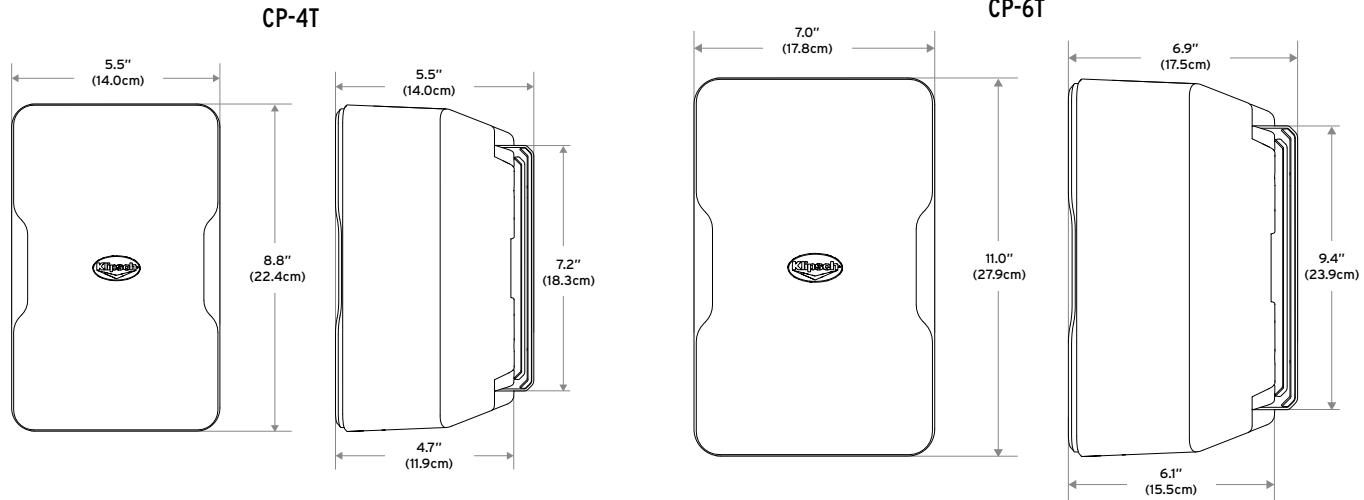

BEFORE SPEAKER INSTALLATION/CONNECTION

Tools/Parts Needed For Installation:

- A level
- A pencil
- A Philips #2 screwdriver or Phillips #2 bit with a drill with a LOW TORQUE SETTING
- Two #10 or #12 2.5-3 inch (4-5cm) Pan Head Screws for each speaker for mounting into wall stud OR minimum 10 lb. (5 kg) Wall Anchors for mounting if stud unavailable
- (If using Safety Cables) One 1" (2.5cm) long, 1/4"- 20-thread screw for each speaker

STEP 1

Typical Wall-Mounting With Included Bracket (Level not included)

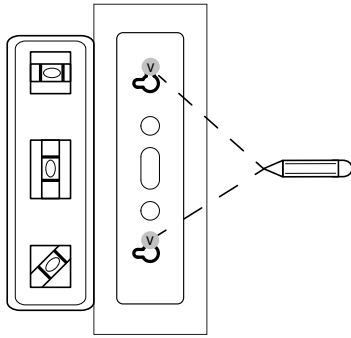

OR

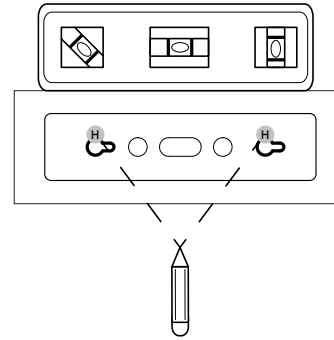

If Wall/Wall Corner or Ceiling/Wall Corner Mounting With Included Bracket

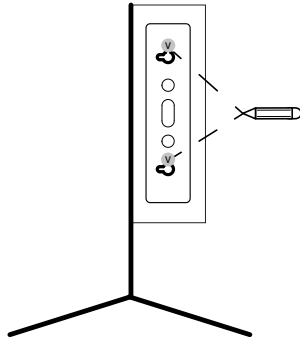

OR

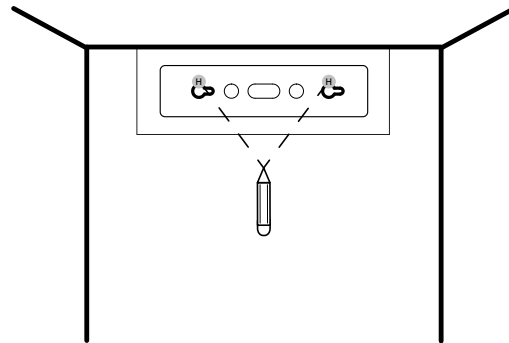

Choose speaker location and run speaker wire to location. Use included template and a level to mark bracket hole locations where speaker will be mounted.

STEP 2

Run speaker wire (and Safety Cable if used) through hole in bracket back and attach wall bracket to wall.

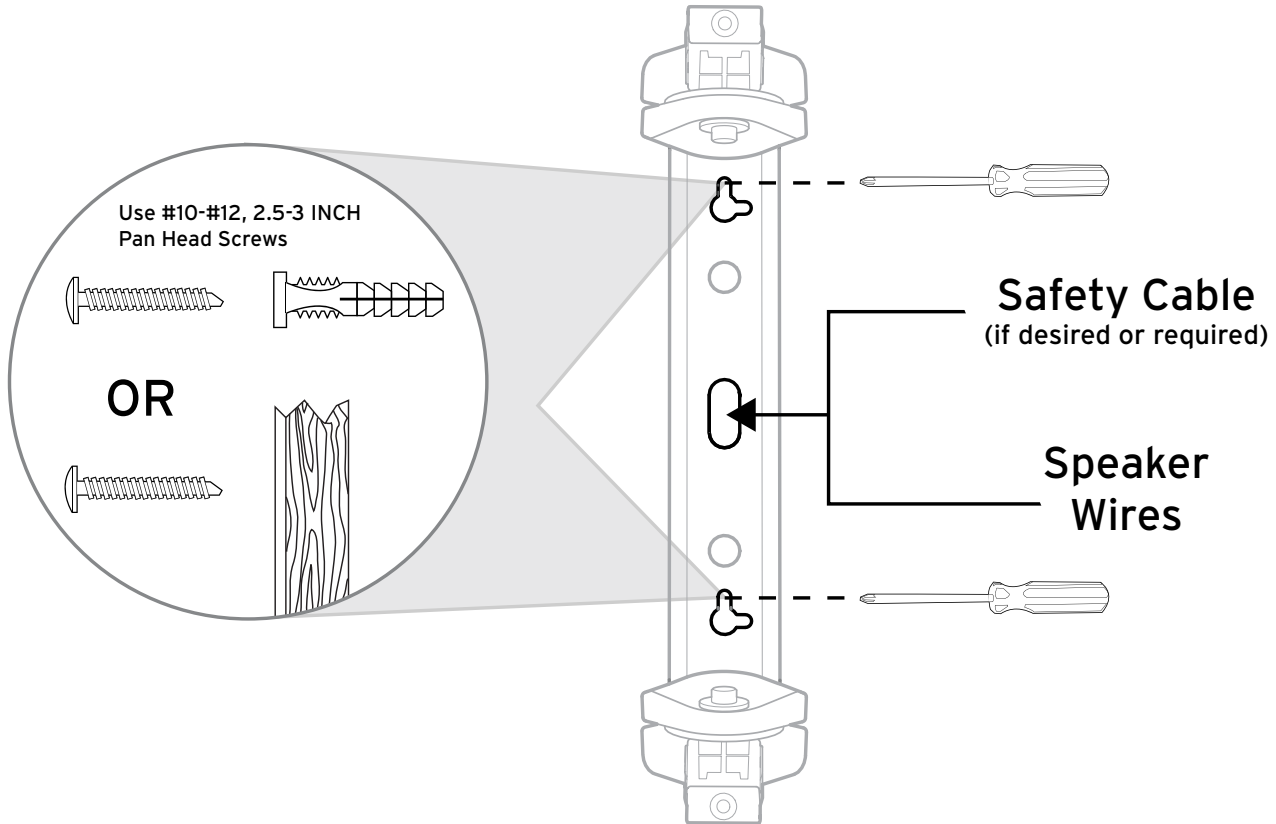

STEP 3

Remove front terminal cover then slide speaker partially onto mounted bracket arms. Channel speaker wire from rear slot through front opening while keeping speaker in position with hand.

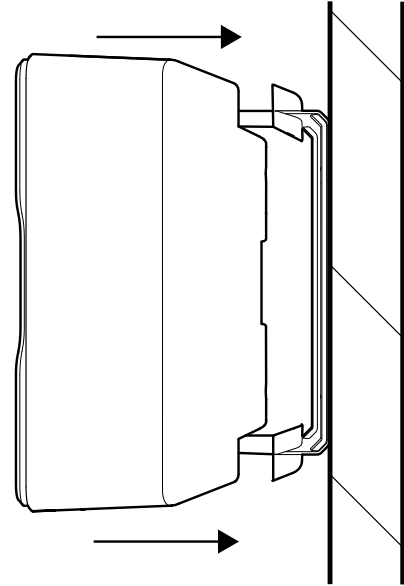
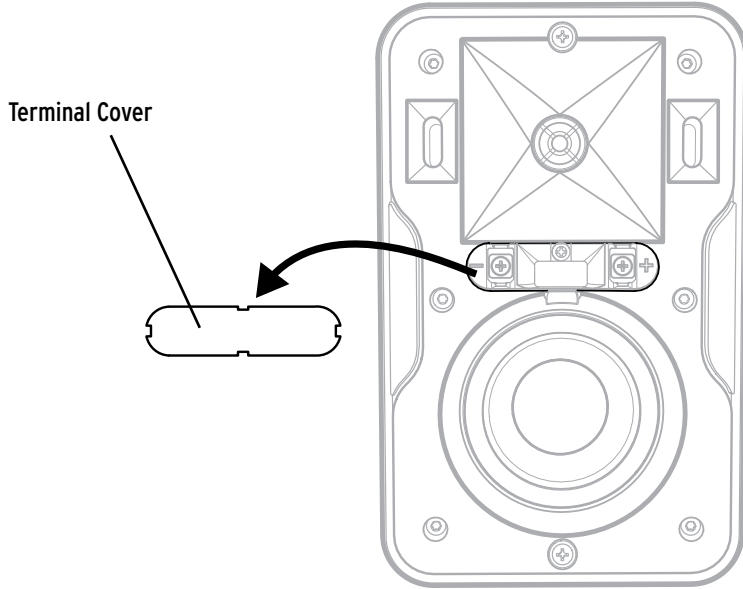

STEP 4

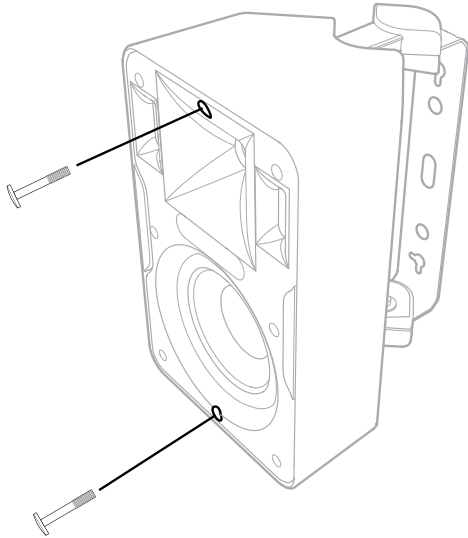

To keep speaker on bracket while adjusting use Phillips head screwdriver (or drill/screwdriver bit AT LOW TORQUE SETTING) and partially screw in front top/bottom bracket screws (2-3 revolutions) then gently pull out speaker to detente position 3/4ths of way on bracket.

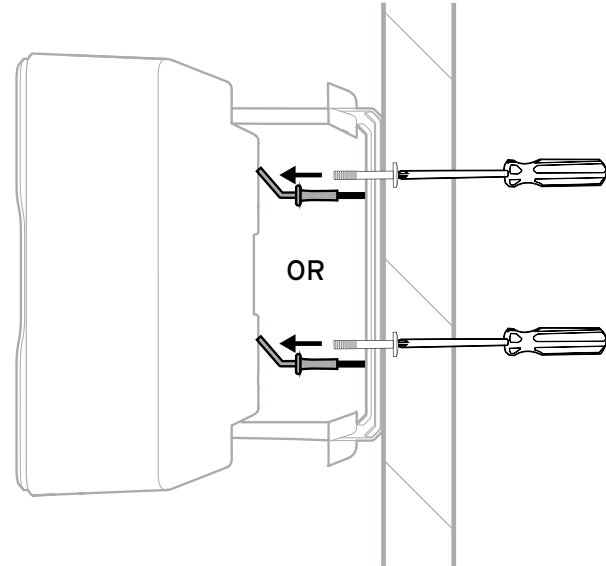

IF USING A SPEAKER SAFETY CABLE
Attach it with a 1" (2.5cm) 20-thread screw (not included) to either threaded insert on speaker rear. Use a LOW TORQUE setting if drill and screwdriver bit are used.

STEP 5

With speaker still loosely on bracket arms, adjust speaker to desired angle on wall.

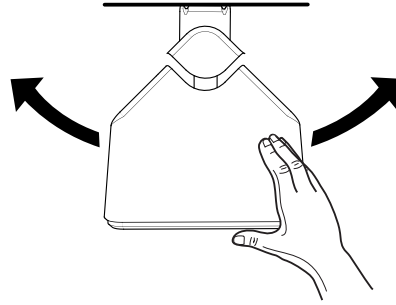

MOUNTING OPTIONS

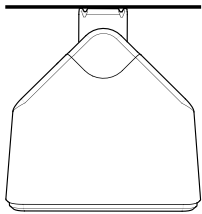

OR

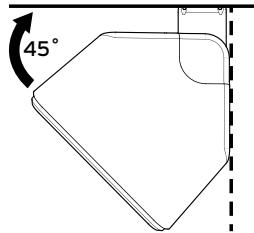

OR

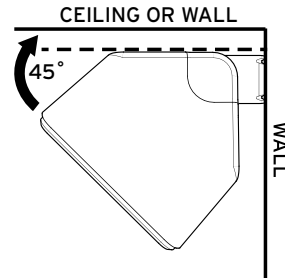
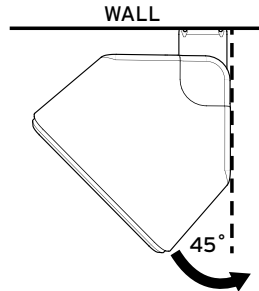
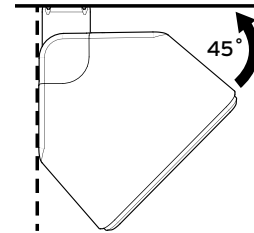

STEP 6

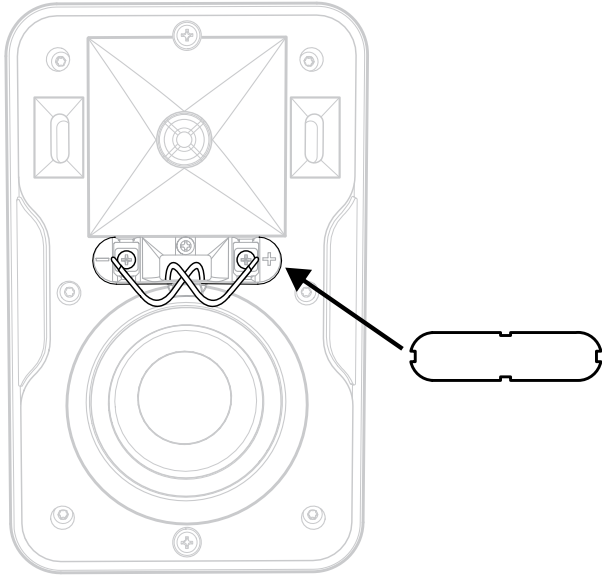

Connect speaker wires to terminals (in parallel with all speakers) with Phillips screwdriver or LOW TORQUE drill/bit.

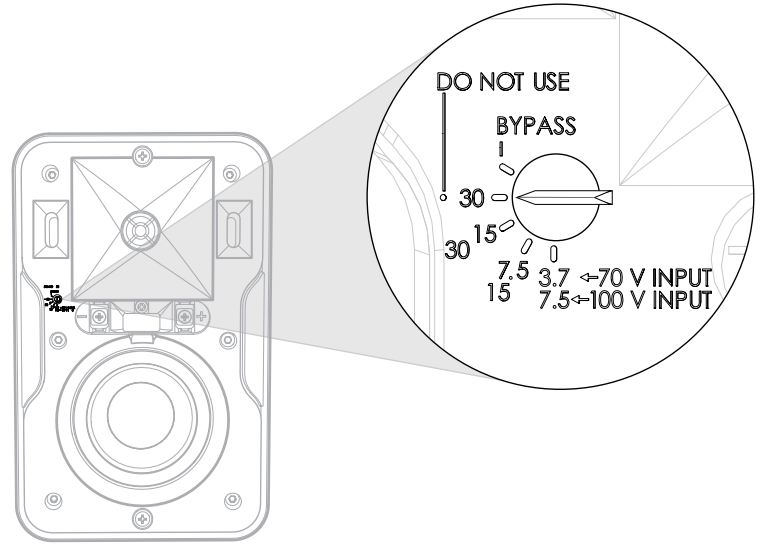

CP-6T SPEAKER ONLY

Select desired wattage tap setting on speaker front for either 70 or 100 Volt operation.

STEP 7

Once speaker is positioned as desired push back all the way back on bracket arms until flush with bracket caps and screw two partially inserted screws all the way in to lock position.

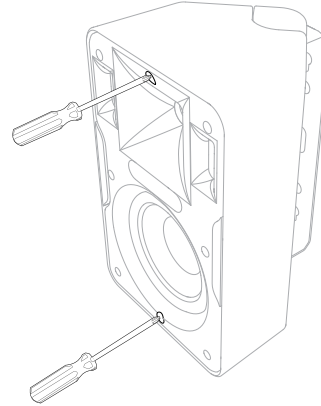

STEP 8

TEST SOUND: Play music/test signal through speaker to make sure connections are tight, and, **IF USING CP-6T**, tap setting is correct for desired volume.

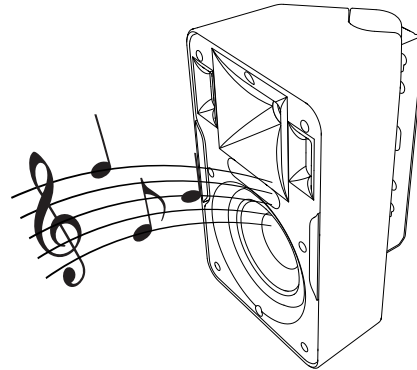

STEP 9

Once speaker is in the final position and tested, attach grill by pressing grill into channel encircling speaker front

***SPEAKER GRILL REMOVAL:** Use included grill removal tool, insert into a top corner and gently pull out. Repeat on a corner next to first one pulled, then pull out grill gently with hand. **NOTE:** the grill is designed to fit snug on speaker to both remain on and to remain tight. Continued removal/reinsertion of grill may make it loose and subject to either vibration or slippage.

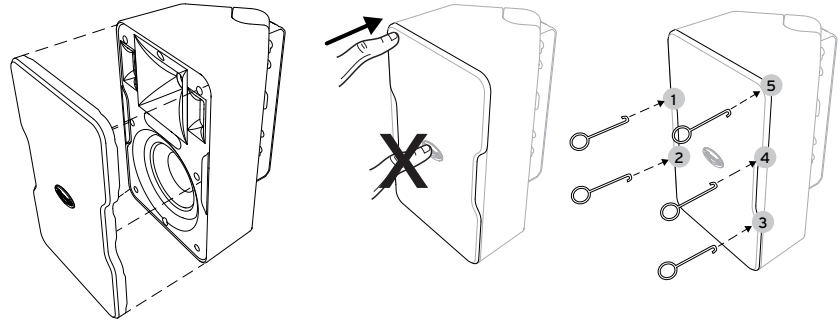

USING A DIFFERENT MOUNTING BRACKET

All CP Series speakers have a 1/4", 20-thread insert on the back bottom that you can attach a different, compatible mount. There is an additional 1/4", 20-thread insert a safety cable can be mounted to.

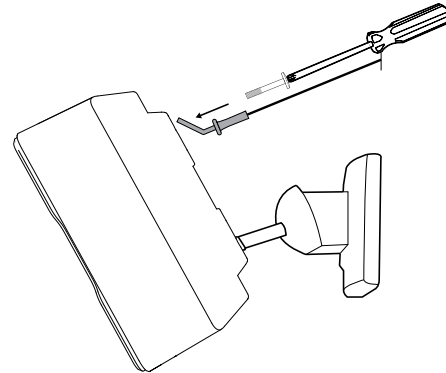

PAINTING THE SPEAKERS

Paint speaker and bracket top/
bottom caps separately.

1. First, clean speaker cabinet and bracket top/bottom caps with mild solvent or mild detergent/water
2. Then create a paint mask for speaker front (baffle) by tracing speaker grill on sheet of thicker, non-porous paper then cutting paper around tracing.
3. Place grill paper mask on front of speaker (over baffle) making sure to also cover grill channel; secure with double sided tape. Do not put tape on woofer. Mask around bracket top/bottom caps making sure not to paint bracket arm and swivel mechanism. Mask logo on grill front.
4. Use a spray paint that is made for plastic and spray speaker cabinet, bracket caps and grill front. Make sure not to cover grill holes. Allow all parts to dry before re-assembling speaker.

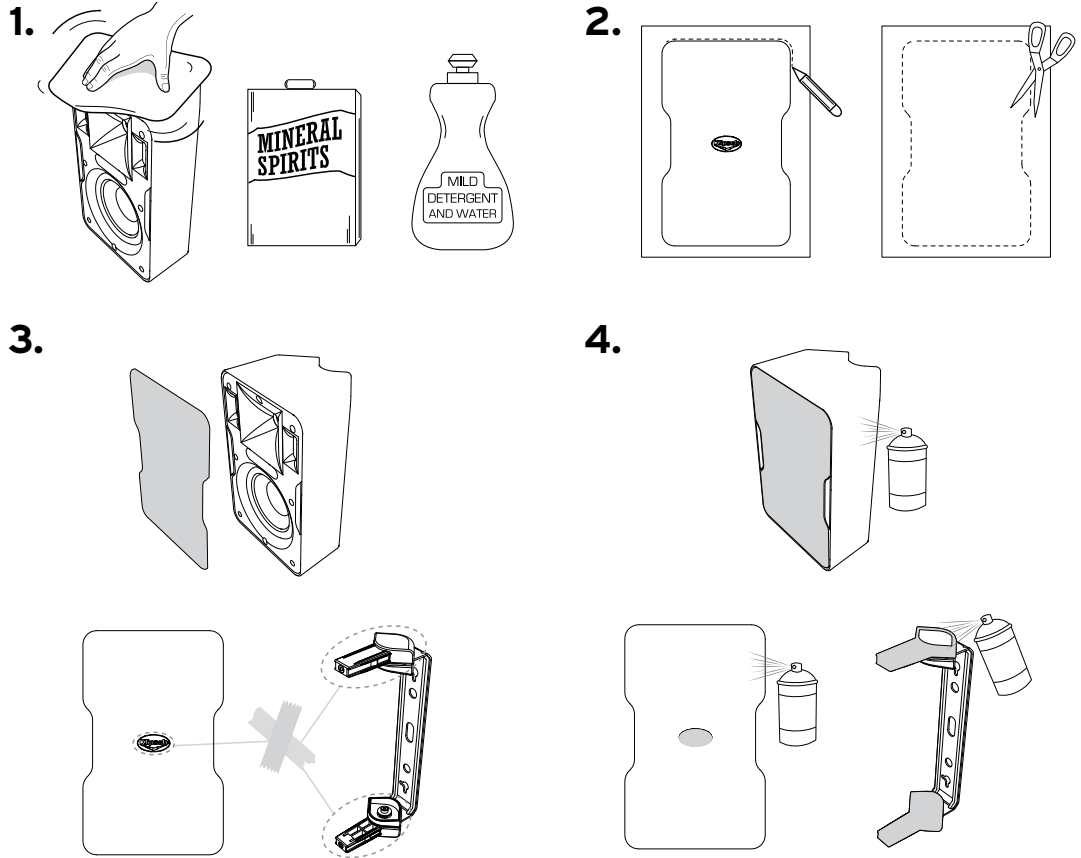

CONNECTION

Wire from amp to first speaker, then from first to second speaker, then from second to third speaker, etc. ("Daisy Chain" wiring). **ALWAYS WIRE IN PARALLEL IN A 70 OR 100 V SYSTEM!**

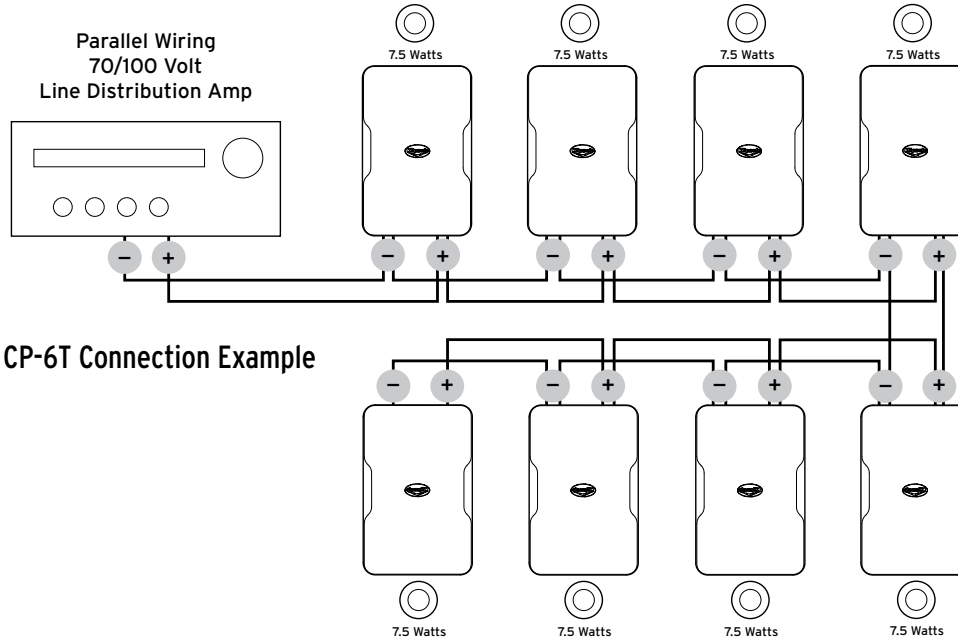

Total System Wattage =
 $7.5 + 7.5 + 7.5 + 7.5 + 7.5 + 7.5 + 7.5 + 7.5 + 7.5 + 7.5$

Total System Wattage = 75 watts

Add 50% Additional Watts = 37.5 watts

**Minimum 70 Volt Amplifier Power Needed:
112.5 = 120 Watt Amplifier**

Total System Wattage = Spk1 Tapped Watts + Spk2 Tapped Watts + Spk3 Tapped Watts +.....

It is recommended to add 50% additional wattage for the best sound and future system expansion

SPEAKER PLACEMENT GUIDELINES

Wall Positioning

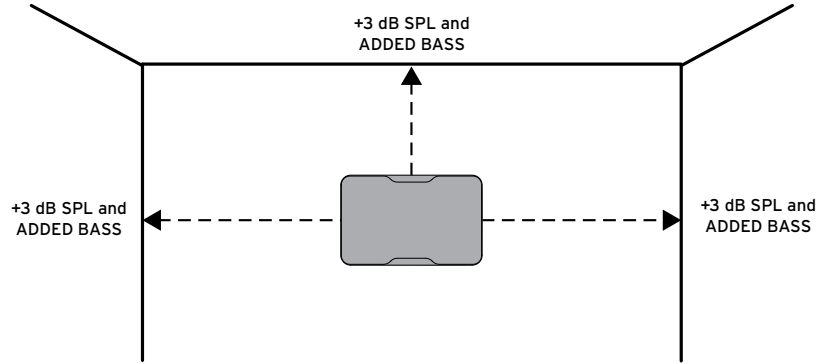

Speaker Spacing

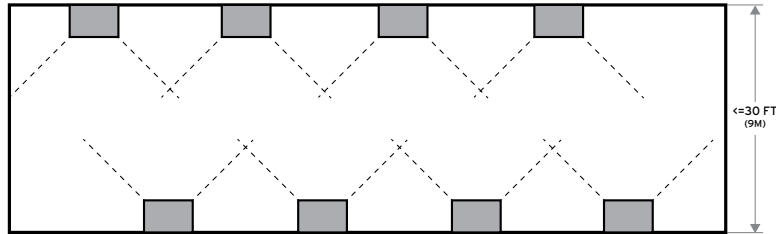

To maintain consistent volume levels across an area, space speakers on wall based on their 90 coverage patterns aimed down to listening area.

To reduce phasing issues affecting sound quality, in areas up to 30 feet (9.1M) wide where speakers are mounted on opposite walls, stagger speakers so none directly face ones on the opposite wall.

SPEAKER PLACEMENT GUIDELINES (CONTINUED)

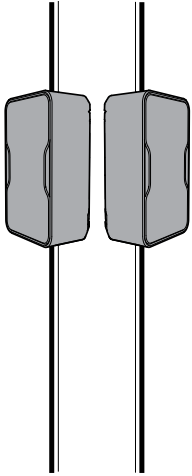

Pole Mounting

Using the 1/4", 20-threaded inserts on the rear of the Klipsch CP speakers and pole mount brackets from a third party provider, the speakers can be mounted to light poles, etc. to cover a 360° pattern for areas such as parking lots indoor/outdoor malls, etc.

Other Guidelines:

- Mount speakers at same height for clearest sound quality
- Sending a mono (left + right) signal to each speaker is typical in a distributed audio system and gives the best coverage for large areas
- Maintain an unobstructed "line of sight" between speakers and listening area

Ambient Noise Levels: Measure at peak business hours to determine highest level

Background Music Levels: Usually 3-6 dB above the ambient noise level of a room

Foreground Music Levels: 10 dB+ above the ambient noise level of a room

Inverse Square Law

For every doubling of distance from a speaker SPL is reduced by 6dB (-6dB)

EXAMPLE

Speaker Sensitivity:
91 dB@1 watt, 1 meter
X (1m) = 91 dB
Y (2m) = 88 dB
Z (4m) = 85 dB

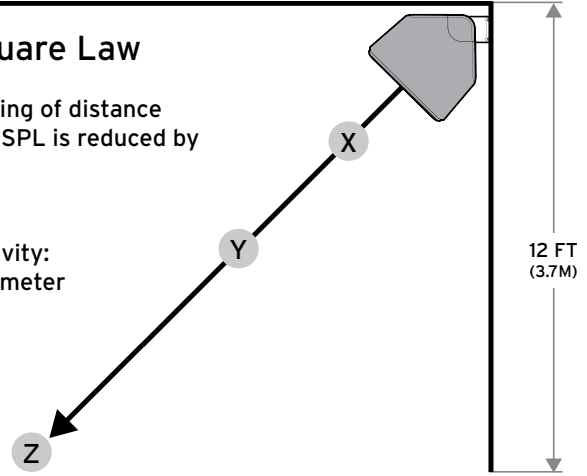

- Rooms with hard surfaces (bare walls, hard floors and ceilings) are considered "live" or reverberant and are best covered with more speakers at lower output levels
- Rooms with soft surfaces (drapes, wall hangings, carpet, upholstered furniture) are considered "dead", absorbing sound, and may require additional speakers placed closer together

CP-4T SPECIFICATIONS

FREQUENCY RESPONSE ¹	100Hz-22kHz +/- 3dB
POWER HANDLING ²	5 watt fixed @ 70V/10 watt fixed @ 100V
MAX CONTINUOUS OUTPUT ³	94 dB @ 70V/97 dB @ 100V
SENSITIVITY ⁴	91 dB
NOMINAL IMPEDANCE	N/A
TWEETER	.75" (1.9cm) aluminum dome tweeter
HIGH FREQUENCY HORN	90° x 90° Tractrix® Horn
WOOFER	3.5" (8.9cm) long-throw IMG woofer
CROSSOVER FREQUENCY	3.2kHz 12dB octave
ENCLOSURE TYPE	Bass-reflex via dual front-firing ports
WEIGHT	4.8 lbs. (2.2kg)
DIMENSIONS	8.8"(22.4cm) H x 5.5"(14.0cm) W x 4.7"(11.9cm) D
DIMENSIONS WITH WALL MOUNT	8.8"(22.4cm) H x 5.5"(14.0cm) W x 5.5"(14.0cm) D
FINISHES	White/Black enclosure and grill
WIRE GAUGE ACCOMMODATED	16
BUILT FROM	2014

¹ 3M anechoic

² IEC 268-5 filtered pink noise with 6dB crest factor

³ Calculated at 1M at power handling power input

⁴ SPL at 1M, anechoic with 2.83V input

CP-6T SPECIFICATIONS

FREQUENCY RESPONSE ¹	83Hz-22kHz +/- 3dB
POWER HANDLING ²	75 w (300 peak) (8 ohm bypass)
MAX CONTINUOUS OUTPUT ³	111 dB (8 ohm bypass),
30 watt Tap	105 dB 70 V/108 dB 100V
15 watt Tap	102 dB 70 V/105 dB 100V
7.5 watt Tap	99 dB 70 V/102 dB 100V
3.75 watt Tap	96 dB 70V/99 dB 100V
SENSITIVITY ⁴	94 dB
NOMINAL IMPEDANCE	8 ohm (8 ohm bypass)
TWEETER	.75" (1.9cm) aluminum dome tweeter
HIGH FREQUENCY HORN	90° x 90° Tractrix® Horn
WOOFER	5.25" (13.3cm) long-throw IMG woofer
CROSSOVER FREQUENCY	3kHz 12dB octave
ENCLOSURE TYPE	Bass-reflex via dual front-firing ports
WEIGHT	6.9 lbs. (3.1kg)
DIMENSIONS	11.0"(27.9cm) H x 7.0"(17.8cm) W x 6.1"(15.5cm) D
DIMENSIONS WITH WALL MOUNT	11.0"(27.9cm) H x 7.0"(17.8cm) W x 6.9"(17.5cm) D
FINISHES	White/Black enclosure and grill
WIRE GAUGE ACCOMMODATED	16
BUILT FROM	2014

¹ 3M anechoic

² IEC 268-5 filtered pink noise with 6dB crest factor

³ Calculated at 1M at power handling power input

⁴ SPL at 1M, anechoic with 2.83V input

Klipsch[®]

KEEPERS OF THE SOUND[™]